

3. To remove door parts.

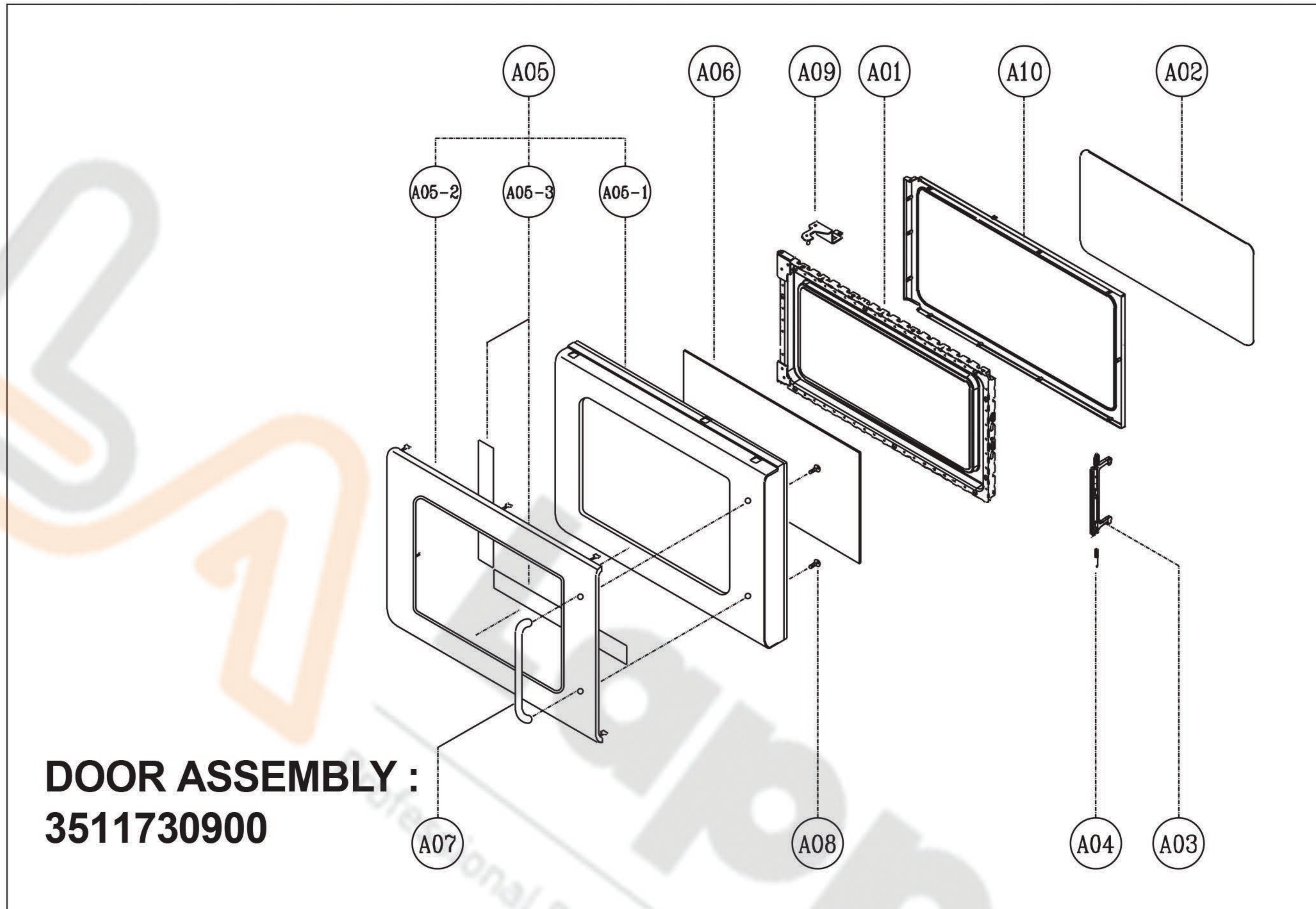

REF No.	PART CODE	PART NAME	DESCRIPTION	Q'TY	REMARK
A00	3511730900	DOOR AS	KOM-9P0C9S	1	
A01	3511731100	DOOR PAINTING AS	KOM-9P0C9S	1	
A02	3517011600	BARRIER-SCREEN *I	PETP T0.1	1	
A03	3513101200	HOOK	POM	1	
A04	3515102300	SPRING HOOK	PW1	1	
A05	3511731200	DOOR SUB AS	KOM-9P0C9S	1	
A06	3517007120	BARRIER-SCREEN *O	TEMP GLASS T3.2 CLEAR	1	
A07	3512604800	HANDLE DOOR	ABS CR COATING	1	
A08	7001401011	SCREW MACHINE	PAN 4X10 MFZN	2	
A09	3515204900	STOPPER HINGE *T AS	KOC-1B0K0S	1	
A10	3512302410	GASKET DOOR	LUPOL 2300	1	

- 1) Remove the gasket door from the door painting as.
- 2) Remove the barrier screen inner from the door painting as.
- 3) Remove the door sub as from the door painting as.
- 4) Remove the stopper hinge top as from the door painting as.
- 5) Remove the spring hook and the hook from the door painting as.
- 6) Remove the barrier screen outer from the door sub as.
- 7) Reverse the above steps for reassembly.

5. To remove control panel parts.

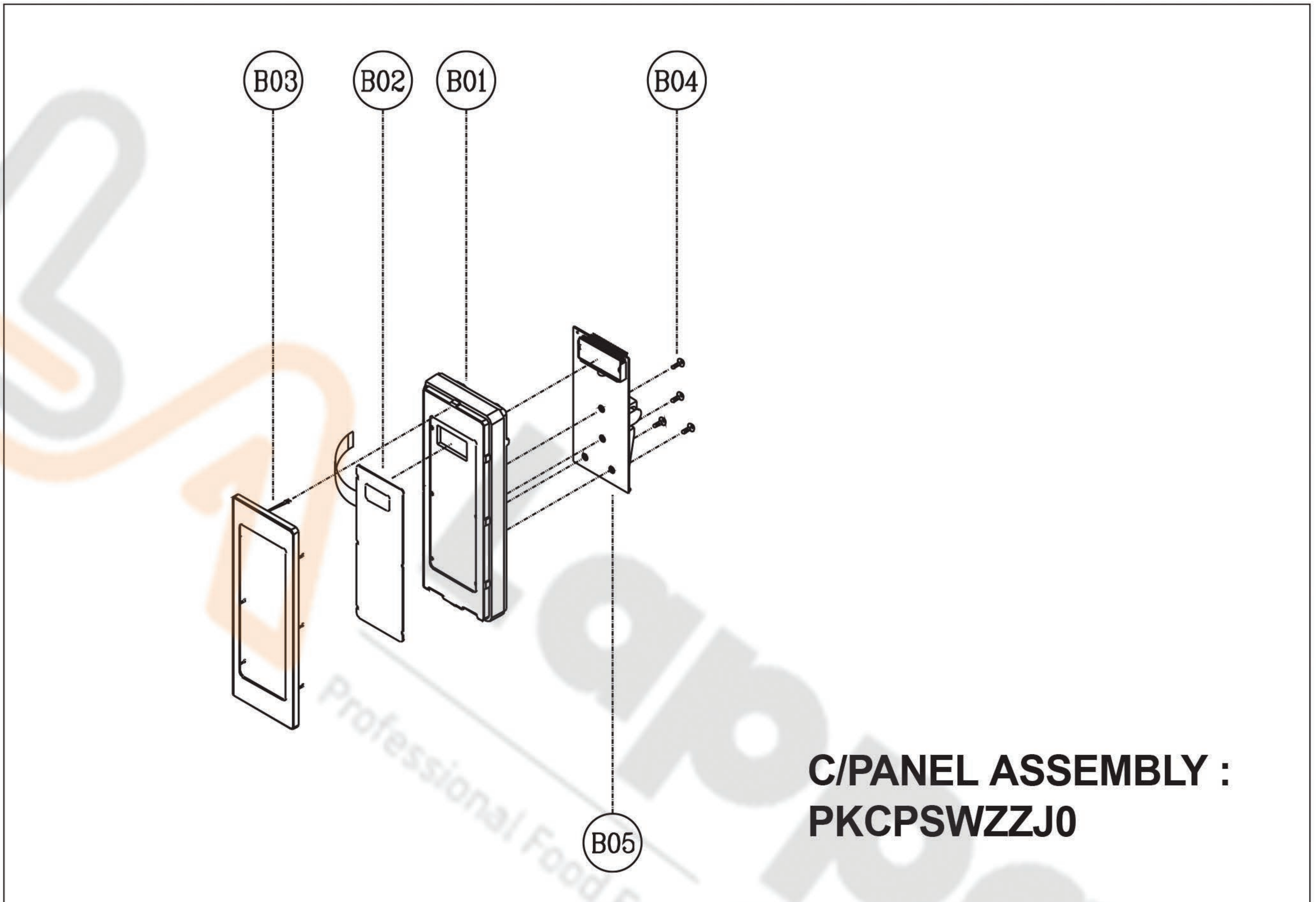

REF No.	PART CODE	PART NAME	DESCRIPTION	Q'TY	REMARK
B00	PKCPSWZZJ0	CONTROL-PANEL AS	KO	1	
B01	3516741600	CONTROL-PANEL	ABS SG-175, SG-0760D	1	
B02	3518573900	SWITCH MEMBRANE	KO	1	
B03	3511621100	DECORATOR C-PANEL	STS430 T0.5 H/L	1	
B04	7122401211	SCREW TAPPING	T2S TRS 4*12 MFZN	4	
B05	PKMPMSB710	PCB MAIN MANUAL AS	KO	1	

- 1) Remove the screw which secure the control panel as, push up two snap fits and draw forward the control panel assembly.
- 2) Remove four screws which secure the PCB assembly to the control panel as.
- 3) Disconnect membrane tail from the connector of the PCB assembly.
- 4) Remove the PCB from the control panel sub as.
- 5) Reverse the above steps for reassembly.

6. To remove guide wind parts.

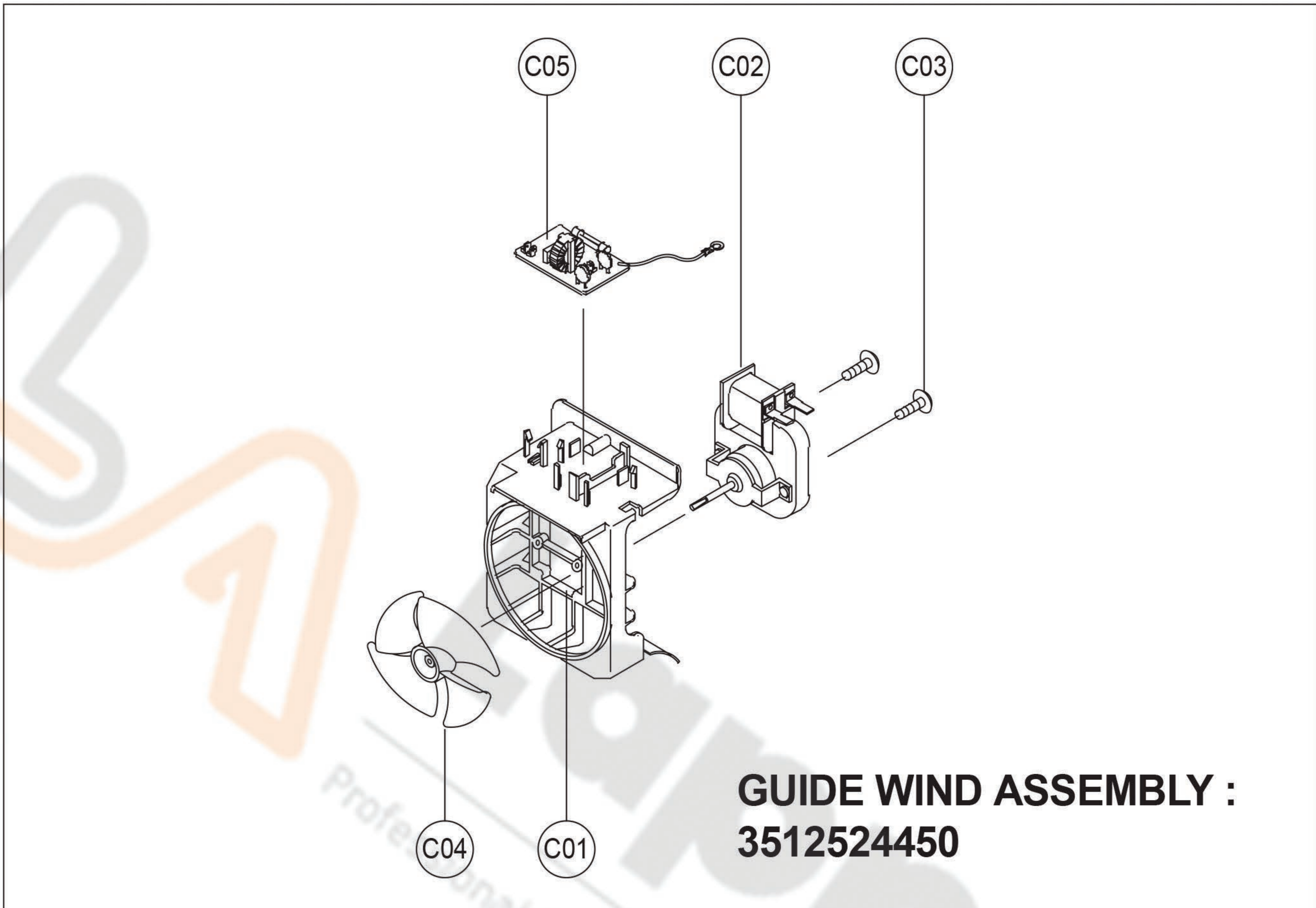

REF No.	PART CODE	PART NAME	DESCRIPTION	Q'TY	REMARK
C00	3512524450	GUIDE WIND AS	KOR		
C01	3512515300	GUIDE WIND	PP	1	
C02	3963514380	MOTOR SHADED POLE	230V 50Hz OEM-15DWC2-C03	1	
C03	7121403011	SCREW TAPPING	T2S PAN 4X30 MFZN	2	
C04	3511800100	FAN	P.P GF20	1	
C05	3518605500	NOISE-FILTER	DWLF-M07	1	

- 1) Remove two screws for earthing and for fixing to rear-plate.
- 2) Remove the noise filter from the guide wind.
- 3) Pull the fan from the motor shaft.
- 4) Remove two screws which secure the motor shaded pole.
- 5) Remove the motor shaded pole.
- 6) Reverse the above steps for reassembly.

WIRING DIAGRAM

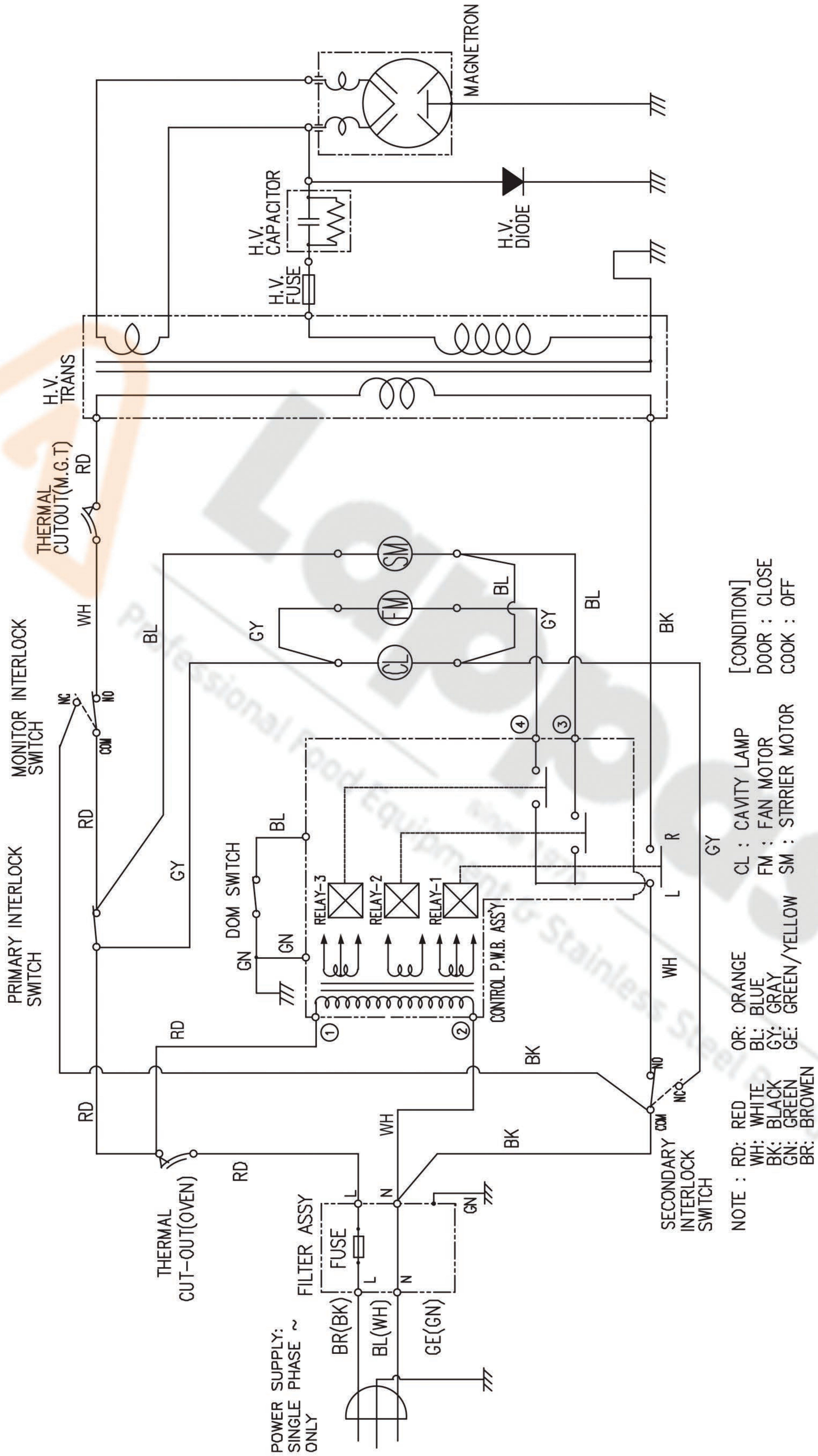

EXPLODED VIEW AND PARTS LIST

1. DOOR ASSEMBLY

Refer to Disassembly and assembly.

2. CONTROL PANEL ASSEMBLY

Refer to Disassembly and assembly.

3. GUIDE WIND ASSEMBLY

Refer to Disassembly and assembly.

4. TOTAL ASSEMBLY

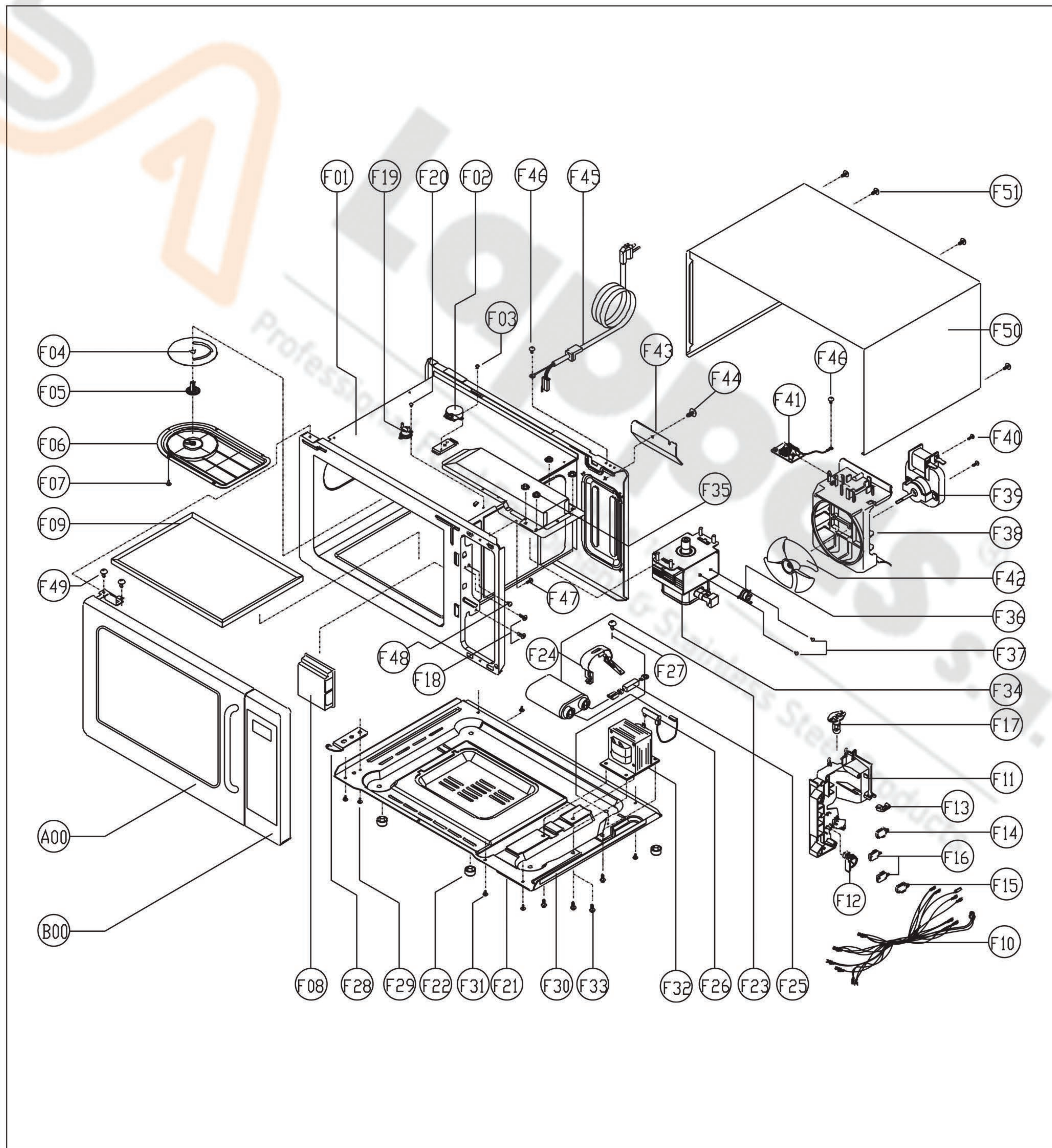

REF. NO	PART CODE	PART NAME	DESCRIPTION	Q'TY
A00	3511730900	DOOR AS	-	1
B00	PKCPSWZZJ0	CONTROL-PANEL AS	-	1
F01	3516121900	CAVITY AS	-	1
F02	3966031300	MOTOR SYNCRO	SM16F -HK36T1FY	1
F03	7121400611	SCREW TAPPING	T2S PAN 4X6 MFZN	1
F04	3517101600	STIRRER BLADE	AL050-H18 T0.7	1
F05	3517402400	COUPLER STIRRER	PPS	1
F06	3511410100	COVER STIRRER	PP	1
F07	4414H50000	FIXTURE AS	KOG-36150S	1
F08	3511410000	COVER HOLE *I	PP	1
F09	3517213100	TRAY AS	- TRAY CEILING	1
F10	3512784900	HARNESS MAIN	-	1
F11	3513816000	LOCK	PP	1
F12	3513700800	LEVER LOCK	POM	1
F13	3513702100	LEVER SW MICRO	POM,KOG-846T0S	1
F14	5S766G10G0	SW MICRO	SZM-V16-FD-93 D (400G)	1
F15	3518571000	SWITCH PUSH	V0303A2 / MP101C	1
F16	4415A66910	SW MICRO	VP-531A-OF/SZM-V16-FA-61	2
F17	3513601600	LAMP	BL 240V 25W T25 C7A H187	1
F18	7122401211	SCREW TAPPING	T2S TRS 4*12 MFZN	2
F19	3518906510	THERMOSTAT	OFF:85 ON:50 H #187	1
F20	7121400611	SCREW TAPPING	T2S PAN 4X6 MFZN	1
F21	3510319800	BASE	SBHG T0.8	1
F22	3512101400	FOOT	DASF-310	4
F23	3518303710	CAPACITOR HV	2300V 1.10UF #187 CLASS P	1
F24	441X304112	HOLDER HV CAPACITOR	SECC 0.8T	1
F25	3518401410	DIODE HV AS	HV03-12 400MA 12000V #187	1
F26	3518701610	FUSE HV	5KV 1A	1
F27	7S432X4081	SPECIAL SCREW	TT3 TRS 4X8 SE MFZN	1
F28	3515202800	STOPPER HINGE *U AS	KOR-121M0A	1
F29	7272400811	SCREW TAPTITE	TT3 TRS 4X8 MFZN	1
F30	3517304600	FOAM	CR 6TX220X30	1
F31	7S312X40A1	SCREW SPECIAL	T1 TRS 4X10 SE MFZN	6
F32	3518121760	TRANS HV	R9S59A DS30	1
F33	3516003700	SPECIAL SCREW	TT3 HEX 4X8 FLG MFZN	4
F34	3518003810	MAGNETRON	2M248H(DW)-B	1
F35	7S627W50X1	NUT HEX	NUT FLANGE M5X0.8P MFZN	4
F36	3518903900	THERMOSTAT	OFF:160 ON:115 H #187	1
F37	7121300611	SCREW TAPPING	T2S PAN 3X6 MFZN	2
F38	3512515300	GUIDE WIND	PP	1
F39	3963514380	MOTOR SHADED POLE	230V 50HZ OEM-15DWC2-C03	1
F40	7121403011	SCREW TAPPING	T2S PAN 4X30 MFZN	2
F41	3518605500	NOISE-FILTER	DWLF-M07	1
F42	3511800100	FAN	P.P GF20	1
F43	3511409500	COVER HOLE *O	SBHG T0.8	1
F44	7122401211	SCREW TAPPING	T2S TRS 4*12 MFZN	1
F45	35113V5QM5	CORD POWER AS	3X1.0 80X80 120-RTML RUBBER	1
F46	7122401011	SCREW TAPPING	T2S TRS 4*10 MFZN	2
F47	7122401211	SCREW TAPPING	T2S TRS 4*12 MFZN	1
F48	7122400811	SCREW TAPPING	T2S TRS 4*8 MFZN	1
F49	7272400811	SCREW TAPTITE	TT3 TRS 4X8 MFZN	3
F50	3510810620	CABINET	STS 430 NO4 T0.5	1
F51	7S312X40A1	SCREW SPECIAL	T1 TRS 4X10 SE MFZN	4