

Ψυγείο LPR-78LW

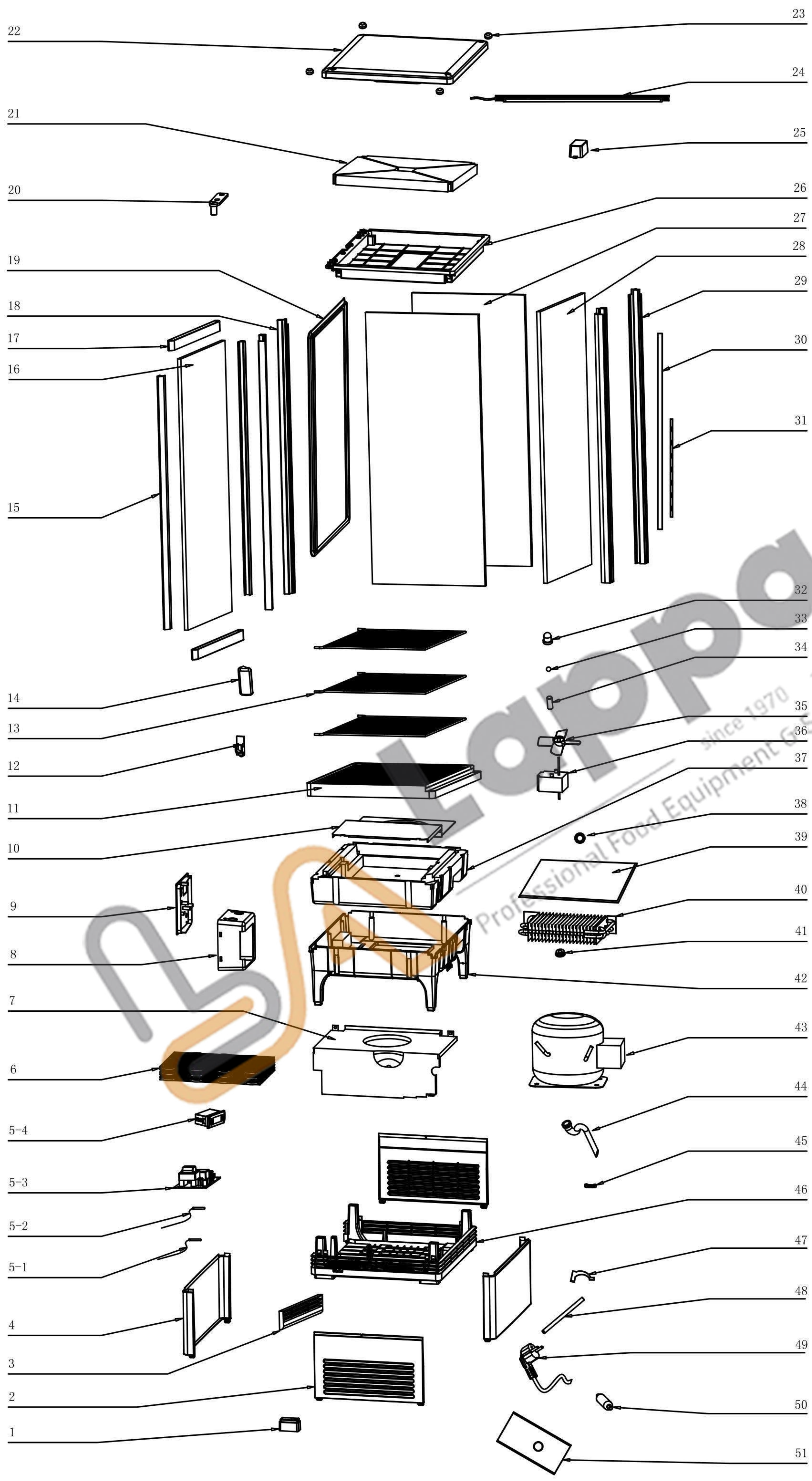

51	1.1.B.B17.04	Metal base of fan motor	0.31
50	1.1.A.A04.01	Dry filter	1.00
49	1.1.A.A08.02.78	Power cord	1.80
48	1.1.B.B06.26	Charging pipe	0.20
47	1.1.C.C44.01	Pipe clip	0.10
46	1.1.C.C25.15	Plastic fence	4.60
45	1.1.C.C24.03	Wire board	0.10
44	1.1.C.C41.13	Upper/Bottom seep tube	0.34
43	1.1.A.A02.01	Compressor	62.39
42	1.1.C.C18.04	Plastic base	4.22
41	1.1.C.C41.01	Motor fixed ring	0.10
40	1.1.A.A10.27.A2	Evaporator	7.90
39	1.1.C.C40.01	Evaporator tray	0.30
38	1.1.B.B10.06	Fan blade spring	0.10
37	1.1.D.D08.02.02	Foam base of evaporator	1.70
36	1.1.A.A03.05.08	motor fan	7.20
35	1.1.C.C17.04	Fan blade	0.21
34	1.1.B.B09.03	Door pin	0.10
33	1.1.B.B04.24.02	Steel ball	0.10
32	1.1.C.C13.01	Bush	0.10
31	1.1.B.B03.01.A1	Top and bottom stainless iron piece	0.13
30	1.1.B.B03.05	Side stainless iron piece	0.20
29	1.1.C.C56.44	Back Pole	1.42
28	1.1.E.E2.01.12	Back glass	4.10
27	1.1.E.E2.01.11	Side glass	3.61
26	1.1.C.C05.63	Light ceiling	4.10
25	1.1.A.A01.10.30	Led Power Drive	3.90
24	1.1.A.A01.14.09	LED Light	6.48
23	1.1.C.C03.01	Screw cover	0.10
22	1.1.C.C01.54	Upper cover	3.30
21	1.1.D.D08.03.09	Lamp insert foam	0.71
20	1.1.B.B09.01	Upper gemel	0.10
19	1.1.E.E1.55	Door gasket	3.30
18	1.1.C.C56.43	Front pole	1.20
17	1.1.C.C11.01	Lower door frame	0.50
16	1.1.E.E2.02.09	Door glass	3.98
15	1.1.C.C38.07	Right and left door pole	0.94
14	1.1.C.C12.14	Handle	0.11
13	1.1.B.B02.01.01	Shelf	2.34
12	1.1.C.C10.41	Shelf clip	0.10
11	1.1.C.C14.01	Vent tray	3.70
10	1.1.C.C16.02	Evaporator protect board	0.53
9	1.1.C.C34.01.01	Control panel	0.60
8	1.1.C.C21.01	Control box	0.60
7	1.1.B.B05.02	cushion of Condensator	1.30
6	1.1.A.A09.01	Condensator	5.20
5-4	1.1.A.A17.06.01	Temperature Display	2.60
5-3	1.1.A.A17.01.01	Main Circuit Board	7.65
5-2	1.1.L.L24.04.02	Defrost probe	0.45
5-1	1.1.L.L24.04.01	Temperature probe	0.43
4	1.1.C.C15.01.01	Front grill	1.30
3	1.1.C.C26.01	Plastic door	0.50
2	1.1.C.C15.02.01	Side grill	1.00
1	1.1.C.C32.05	Base feet	0.10
No:	Spare parts Code	Des	unit prices